

# HEALTH





# CARE

# F L O O R I N G G U I D E



Sound absorption



Stain resistance



Withstands heavy traffic



Comfort underfoot

## CONTRACT FLOORING

	Geode	Punti	Unito	Tono	Futura	Alba	Bollo Extra	Step	Murale	Ardesia
Entrance		3•4	3•4	3•4	3•4	3•4	2,5•4			
Pathway for visually impaired										
Corridor		3•4	3•4	3•4	3•4	3•4	2,5•4			
Waiting room		3•4	3•4	3•4	3•4	3•4	2,5•4			
Day hospital	2	2		2	2					
Emergency room/acceptance		3•4		3•4	3•4					
Radiology/Diagnostic										
Dialysis	2									
Laboratory	2				2					
Patient's preparation area										
Surgeon's preparation area										
Operating room										
CPR/intensive care room										
Physiotherapy										
Infective disease area										
Computer room										
Office	2	2		2	2					
Restaurant	2			2	2		2,5•4			
Restroom										
Indoor stairway							2,5•4			
Outdoor stairway										
Access pathway										
Product Page	62	58	66	64	60	70	68	84	74	72



Environmental friendly



Antibacterial • Water resistant



Wear resistance



Step



Wet or dry slip resistance



Chemical resistance



Static dissipative



Fire resistance

## SPECIAL SOLUTIONS FLOORING

Static dissipative		Acoustical			Loose-laid			Conductive						
Punti SD	Futura SD	Punti ACU	Futura ACU	Alba ACU	Easy Punti	Easy Futura	Easy Tono	Geode CD	Safety	Loges	Mondoflex	Sport Impact	Sportflex	
														Entrance
														Pathway for visually impaired
														Corridor
														Waiting room
														Day hospital
														Emergency room/acceptance
														Radiology/Diagnostic
														Dialysis
														Laboratory
														Patient's preparation area
														Surgeon's preparation area
														Operating room
														CPR/intensive care room
														Physiotherapy
														Infective disease area
														Computer room
														Office
														Restaurant
														Restroom
														Indoor stairway
														Outdoor stairway
														Access pathway
78	78	78	78	78	42-80	42-80	42-80	78	82	44	88	88	88	Product Page



Visually impaired



Withstands heavy rolling loads



Possibility of heat welding



Flash cover

# HEALIN



## WARM

Mondo floorings, compared to ceramics or other hard surfaces, have a better thermal conductivity value (DIN 52612-1).



# G D E S I G N

## DESIGN

Mondo offers a wide color range from classic colors for institutional design, to very lively colors contributing to the creation of a **healing design perfect for the healthcare environment, especially for childrens' hospitals, pediatrics and obstetrics.**



## ERGONOMICALLY CORRECT

The anti-fatigue properties of rubber flooring **minimize fatigue for surgeons, cardiologists, nurses, and other staff** whose focus is providing the best care for their patients. Comfort underfoot is improved without affecting the movement of heavy rolling loads.

The shock absorption qualities of rubber reduce the risk of injuries when falling compared to other surfaces.



# HEALTHY

## LOW MAINTENANCE

A protective coating is applied during the manufacturing process to make the subsequent maintenance of Mondo's flooring easier.

## EXTRA HYGIENIC SOLUTIONS

### BACTERIOSTATIC THROUGHOUT

Mondo rubber floorings are inherently bacteriostatic and do not require any addition of synthetic antibacterial components or the use of topical coatings.

### CHEMICAL RESISTANCE

Mondo floorings have a good chemical resistance to physiological liquids and hospital reagents.

### WATER RESISTANT

Mondo rubber flooring is non-porous and therefore water resistant and **perfectly hygienic**.



**WALL COVERING**

The wall claddings can be easily disinfected having a perfect junction with the floor.

**MURALE** is a class 1 certified rubber wall covering.

*See page 74 for more details.*



**FLASH COVE**

It is possible to provide a perfect junction between the self covered skirting with the floor where special waterproofing and hygienic conditions are requested (operating rooms).

*See page 86 for more details.*



**HEAT WELDING**

Mondo rubber flooring does not need to be heat welded, however, for a more sterile environment most contract surfaces can be heat welded.

*See page 92 for more details.*

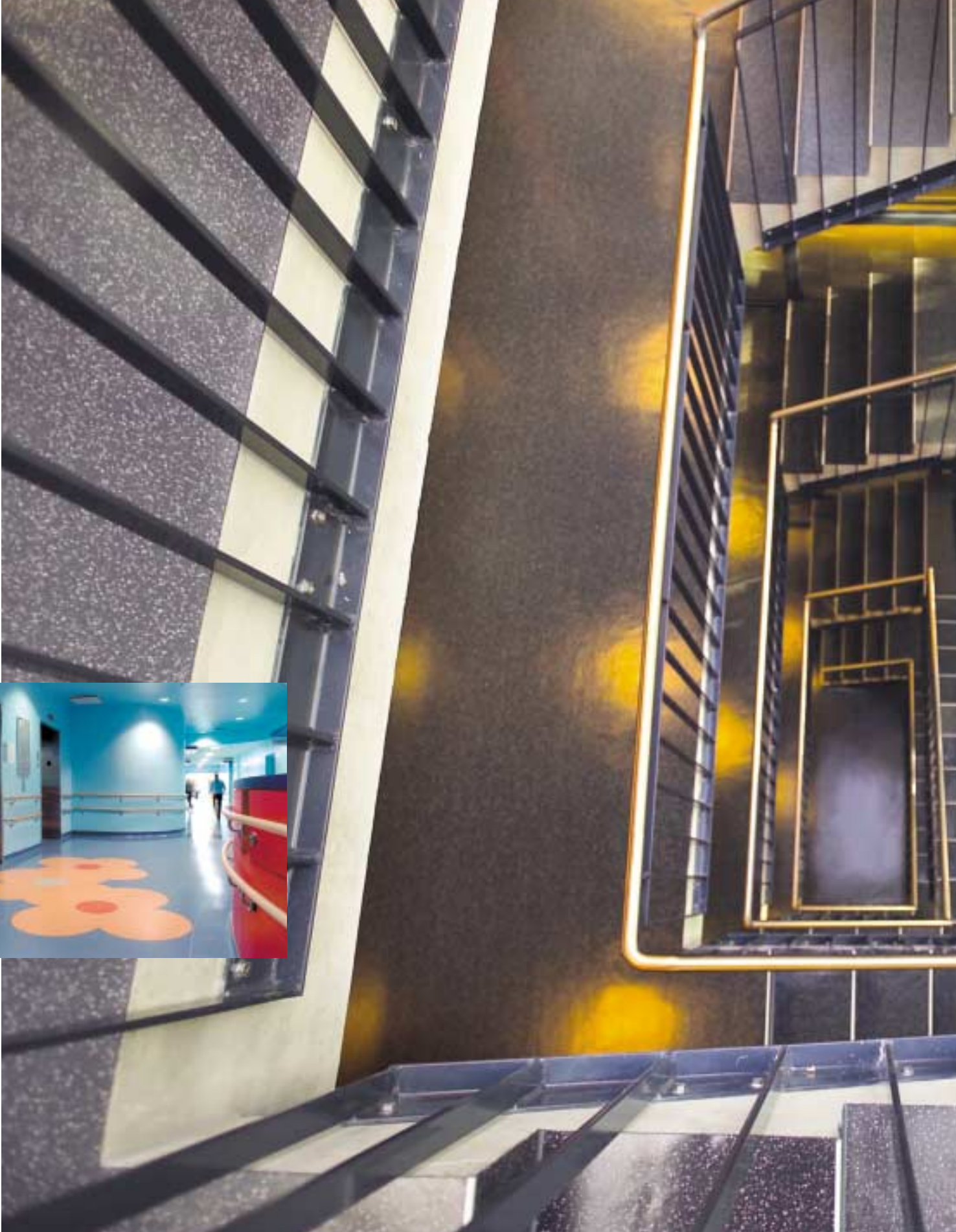

### **FIRE REACTION**

Meets **UNI 8457** and **UNI 9174** standards, and it is certified class 1. It is also certified class B1 according to **DIN 4102** and class M3 according to **NF P 92 501**.



## SAFE FOR THE ENVIRONMENT

Mondo floors do not contain any: plasticizers (phthalates), halogens (PVC), heavy metals (such as Hg, Cd, Sb, Pb, Mo), formaldehyde and asbestos.

Mondo flooring is designed to have a low emission of volatile organic compounds (VOC).

# S A F E

## SAFE TO WALK ON

By its very nature rubber displays optimal capacity to reduce slipperiness to a minimum, to the great advantage, safety and comfort of users. **In compliance with national standards in force.**



## SMOKE EMISSIONS

In case of a fire, the fumes released do not contain any corrosive gases and **meet all international toxicity standards according to BS 6853 (weight sum of toxic smokes R), NF X 10-702 and ASTM E 662.**

## ANTISTATIC

In the standard version rubber displays a natural antistatic response when it is walked on **(EN 1815).**

*See page 78 for more details.*

# SPECIAL

## LOOSE-LAID SYSTEM

Mondo loose-laid floors for healthcare assure a definitive solution to the overcoming of problems quickly, especially when there is an emergency.

The results:

- reduced laying time
- removal of all inconveniences due to demolition (dust, rubble, noise...)
- sound insulation
- high dimensional stability
- good even surface
- heat welding system for a perfect hygiene

See page 80 for more details.

**08:00 AM**

The corridor before the intervention



**08:30 AM**

Restoration of the damaged area and installation of loose-laid tiles

...

Heat Welding for a more sterile environment  
See page 78 for more details.



## REACTION TO FIRE

The floating floors can only be laid on a fireproof support.

# SOLUTION

## APPLICATIONS

Mondo floating laying technical solutions are recommended in the following cases:

- Pre-existing floors that must be preserved or encapsulated
- Rising humidity, high residual humidity, as found in newly laid concrete and sub-floor foundations
- Raised floors to be inspected
- When there is a need to reduce laying times to a minimum
- When there is a need to work in operating premises because not only the laying times are reduced, but also because the area is not soiled

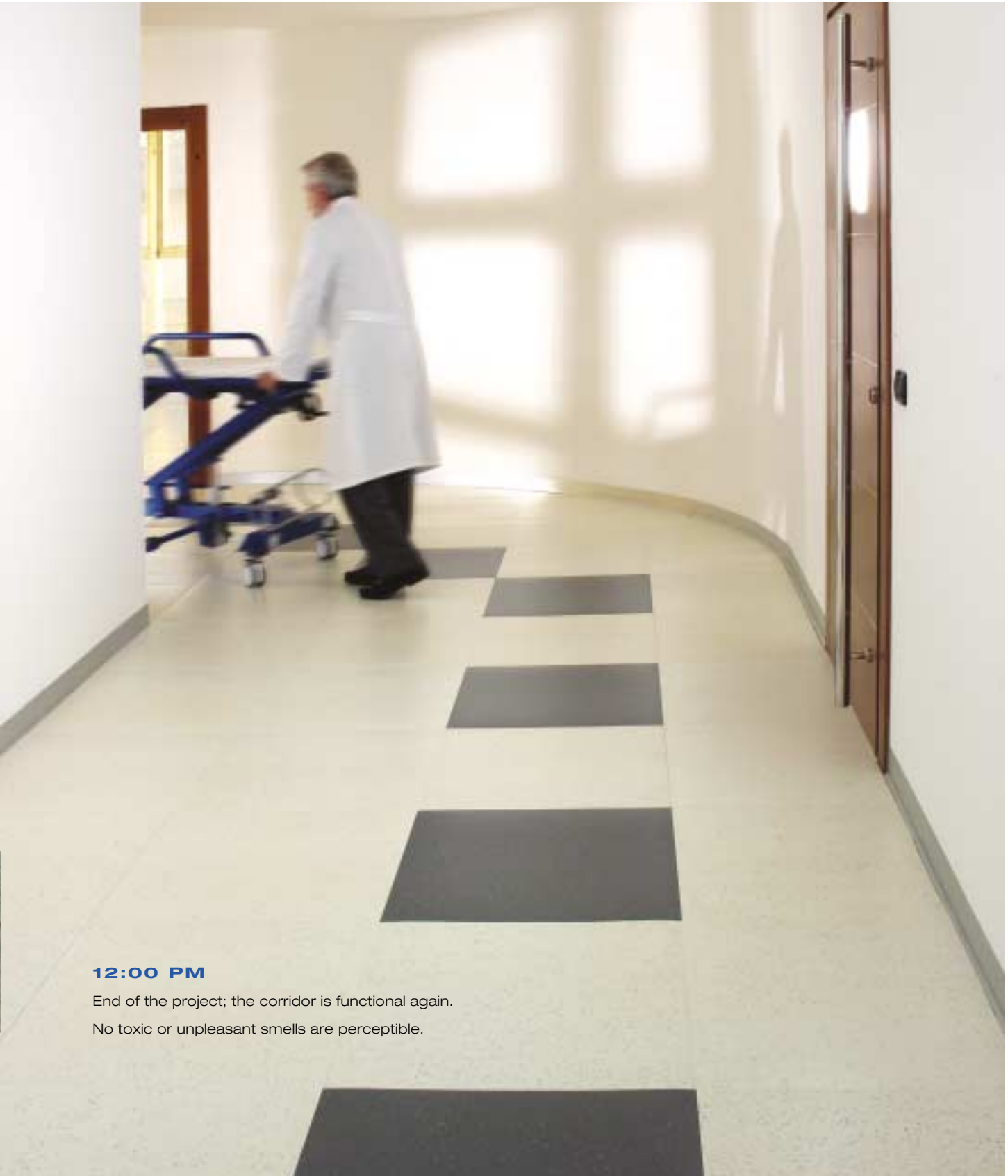

**12:00 PM**

End of the project; the corridor is functional again.  
No toxic or unpleasant smells are perceptible.

# SPECIAL

