

- Z = Variable according to wind zoning.
- *H3 Plywood Packer = Spaced at intervals of 400mm.
- *Fixing with Neoprene Washer = Oversized hole for fixing to allow for expansion and dont fix tight.
- *All transition joints must have angle fillet and a double thickness of membrane.
- *Slate aggregate must be removed where overlap occurs.

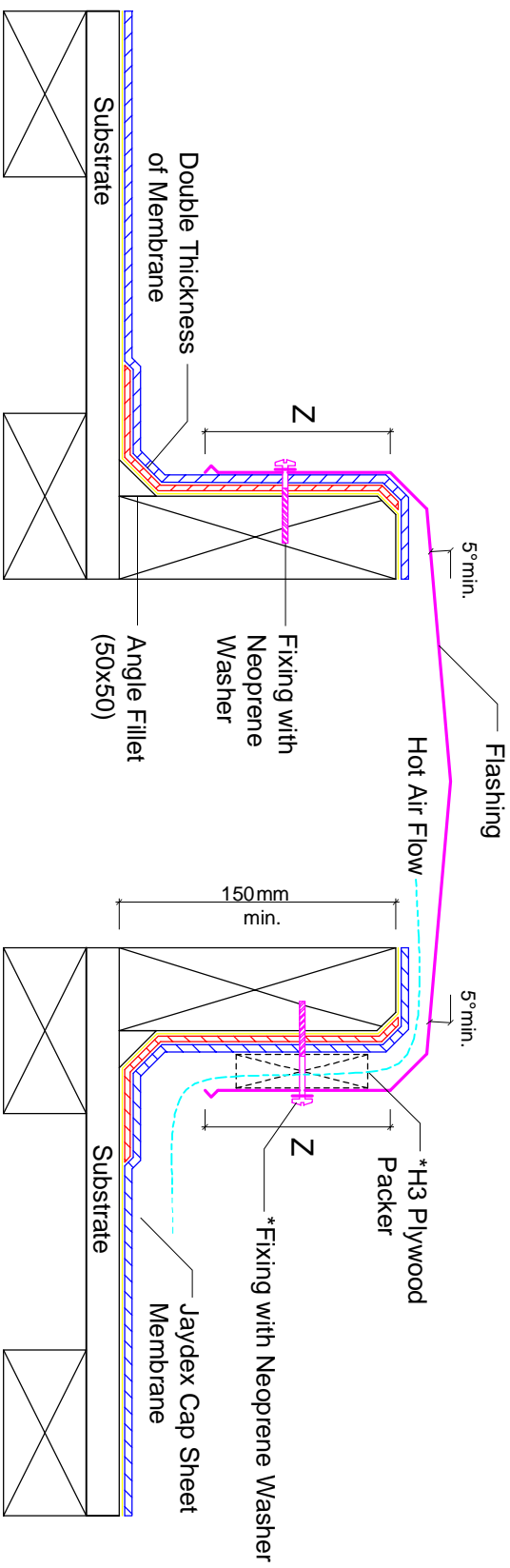

Scale: 1:5

Disclaimer
The detailed drawings as outlined are based on our experience and application procedures and represent the latest information available. No responsibility is taken for uses to which this information may be put, but we advise that where the application is in complete conformity with the appropriate specification a warranty may be available.

We reserve the right to alter or up date the information parameter at anytime without prior notice.

*Copyright



UNIT 3c-3, MARKEN PLACE,
GLENFIELD, AUCKLAND

P.O. Box 100 000
NORTHSHORE MAIL CENTRE

PHONE Bus: (09) 444-1751
FAX (09) 444-0132
E-MAIL jaydex@xtra.co.nz
sales@jaydex.com

ROOF

**RIDGEVENT/
CONSTRUCTION JOINT**

Single Sheet Torch-On Membrane System

Mineral Chipped Surface Finish

RF/06/SS/MC

Date: 06/06 Drawn: SE