

- \*All external corners must be bevelled and all internal corners must have angle fillet.
- \*All corners must have double thickness.
- \*Slate aggregate must be removed where overlap occurs.

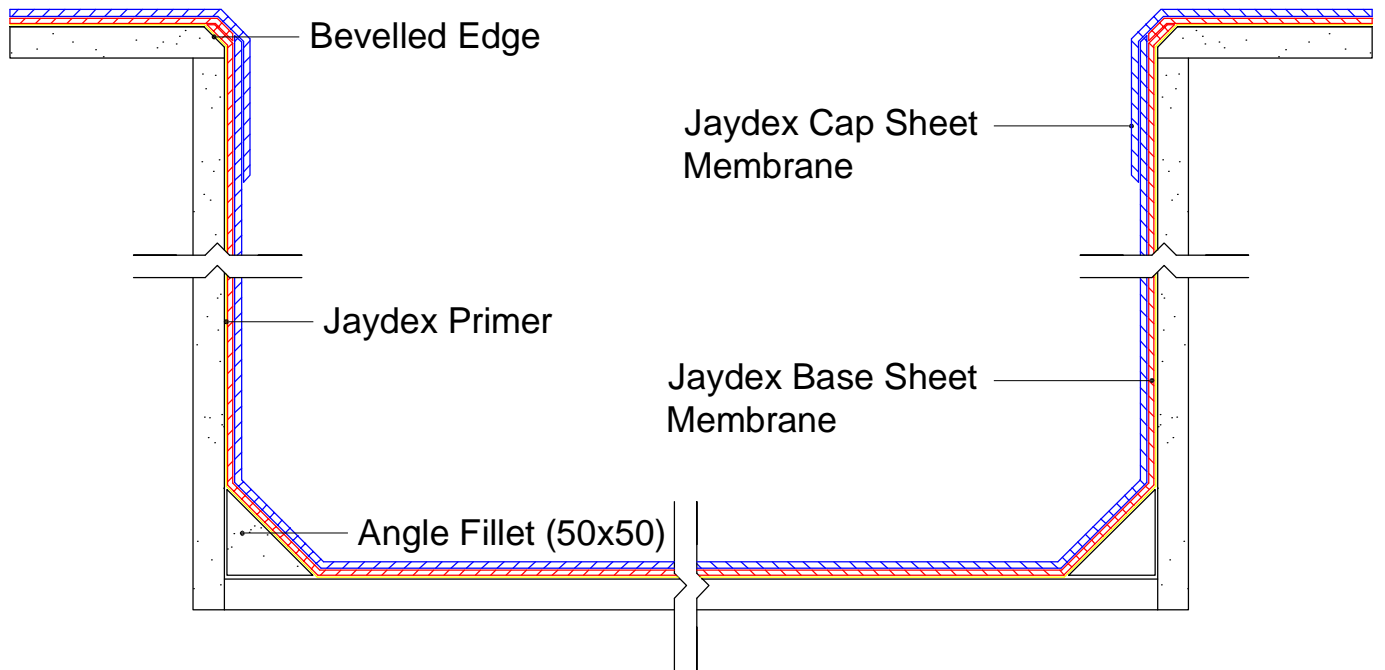

**JAYDEX**  
INTERNATIONAL · LIMITED

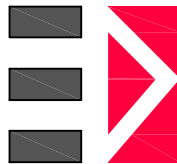

ROOF	INTERNAL GUTTER
Double Sheet Torch-On Membrane System	
Mineral Chipped Surface Finish	
RF/12/DS/MC	Date: 06/06 Drawn: SB

UNIT 3c-3 MARKEN PLACE,  
GLENFIELD, AUCKLAND

PHONE Bus. (09) 444-1751  
FAX (09) 444-0132

E-MAIL jaydex@xtra.co.nz  
lee.jaydex@xtra.co.nz

**Disclaimer**

The detailed drawings as outlined are based on our experience and application procedures and represent the latest information available. No responsibility is taken for uses to which this information may be put, but we advise that where the application is in complete conformity with the appropriate specification a warranty maybe available.

We reserve the right to alter or up date the information parameter at anytime without prior notice.

© Copyright