

- \*100mm min overlap for all upstand / joint laps.
- \*50mm min past the top of angle fillet for all backing strips or upstands.
- \*All internal and external corners must have a double thickness.
- \*All sharp edges must be bevelled and all internal corners must have angle fillets.

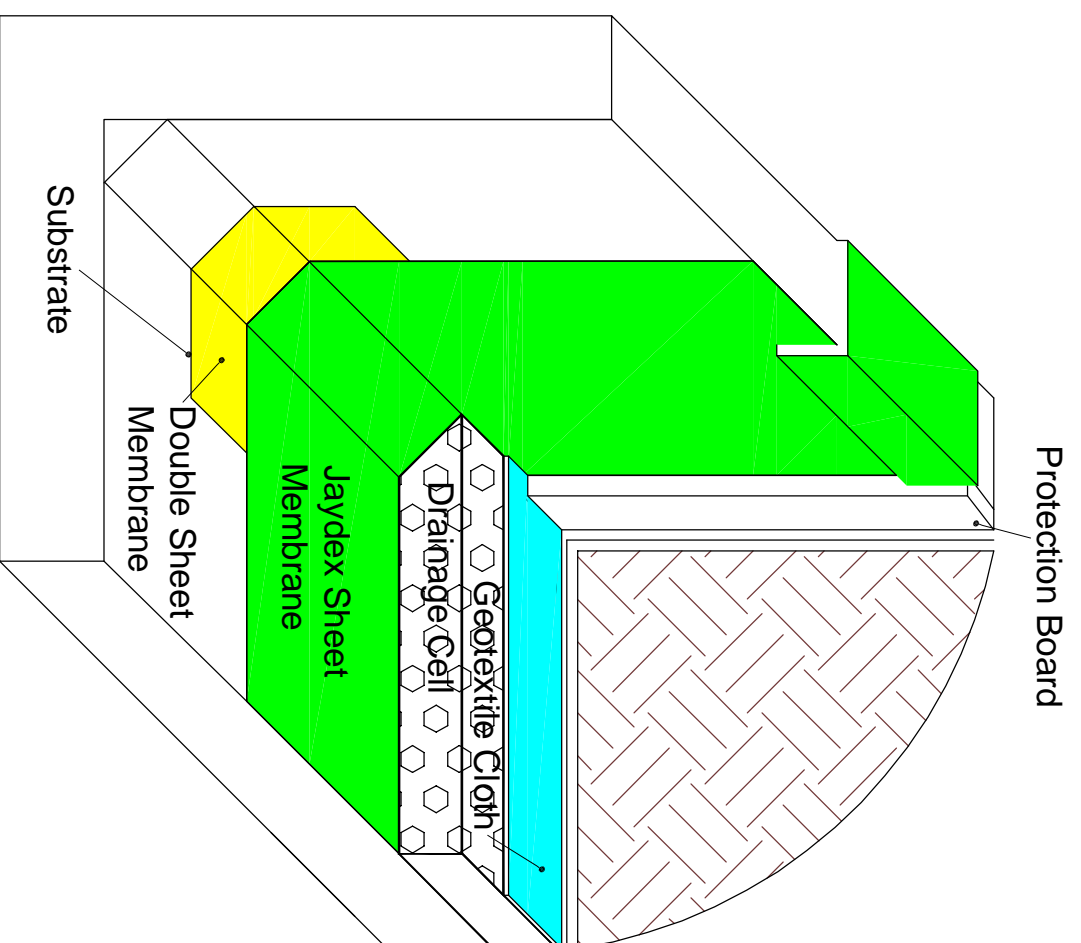
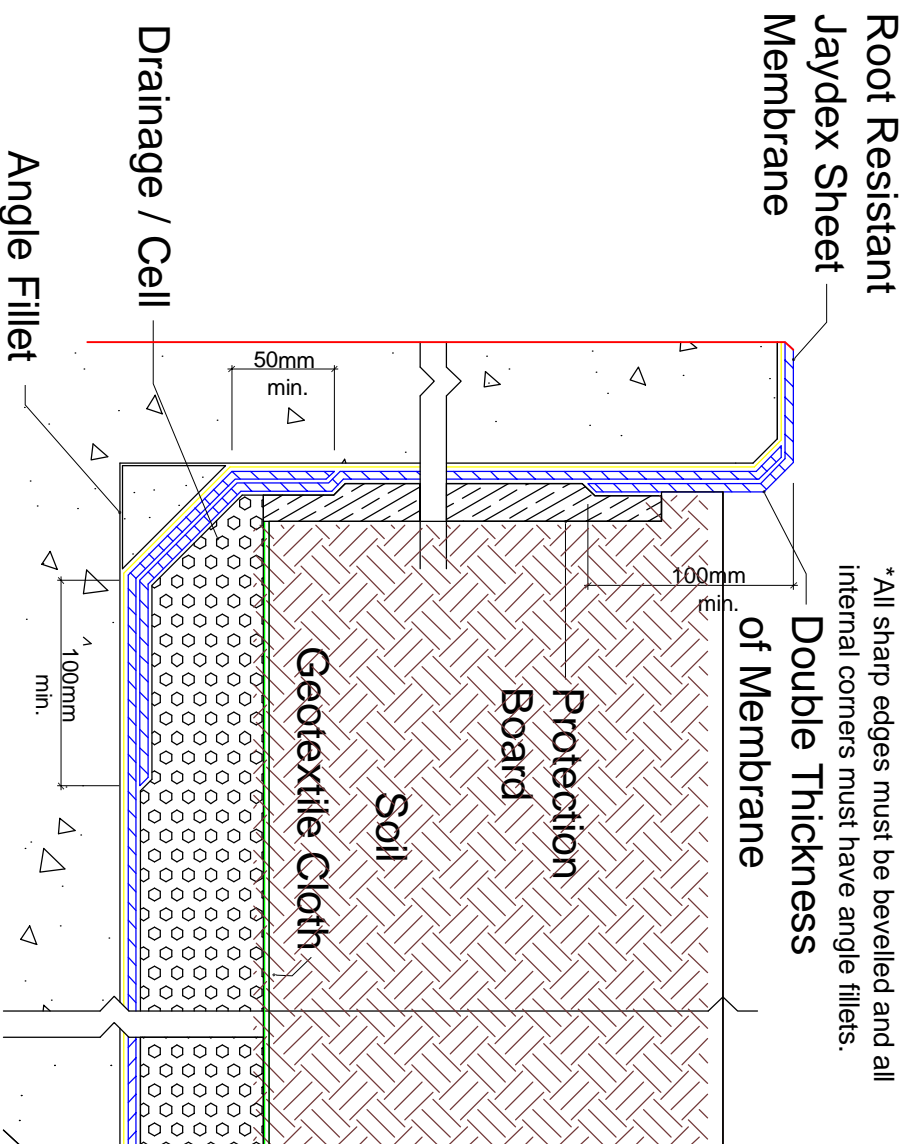

**Disclaimer**  
The detailed drawings as outlined are based on our experience and application procedures and represent the latest information available. No responsibility is taken for users to which this information may be put, but we advise that where the application is in complete conformity with the appropriate specification a warranty may be available.

We reserve the right to alter or up date the information parameter at anytime without prior notice.

\*Copy/right



UNIT 3c-3, MARKEN PLACE,  
GLENFIELD, AUCKLAND

P.O. Box 100 000  
NORTHSHORE MAIL CENTRE

PHONE Bus: (09) 444-1751  
FAX (09) 444-0132

E-MAIL jaydex@xtra.co.nz  
sales@jaydex.com

<b>BELOW GROUND</b>	<b>PLANTER BOX</b>
Single Sheet Torch-On Membrane System	
Sheet / Cell Overlay Barrier	
BG/36/SS/SC	Date: 06/06 Drawn: SB